



trendiswitch.com[®]

0203 5899 520

sales@trendiswitch.com

f /TrendiSwitch

PO BOX 890, Forest Row, East Sussex,
RH19 9LX, United Kingdom

Trendiswitch Limited is a UK Company Registration No. 08849300

TECHNICAL INFORMATION

Q. The product has no screw holes. How does it fit?

A. Trendi switch products use a twin plate system that has a subframe with all fixing holes.

Q. Can I change the colour I have.

A. Yes, Trendi colour faceplates are interchangeable.

Q. Are these a direct replacement for normal switches and sockets?

A. Yes the Trendi Switch range was designed with the idea that they can be swapped with your existing switch.

Q. Does Trendi Switch offer technical support for end users?

A. Yes our technical department can be reached by selecting option 3 on 0203 5899 520.

1-8 Gang Screwless 10 Amp Switches

Structure

1 Gang 10 Amp Switch

front view back view



1 switchplate
2 switch button
3 frame

8 Gang 10 Amp Switch

front view back view

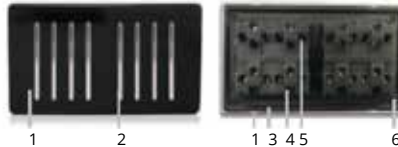

4 circuit box
5 connecting terminal
6 screw

NB Rated voltage and power are on the circuit box
Certified to British Standard CE & CB approved

Installation

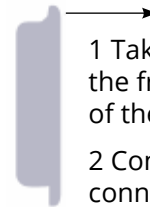

1 Take off switch plate from the frame along the direction of the arrow (above)

2 Connect wire into the connectors (see right)

3 Screw the frame onto the pattress box installed in the wall (two screws enclosed)

4 Clip switch plate back onto the frame, noting direction of the plate (edge with gap faces down)

Switch Wiring

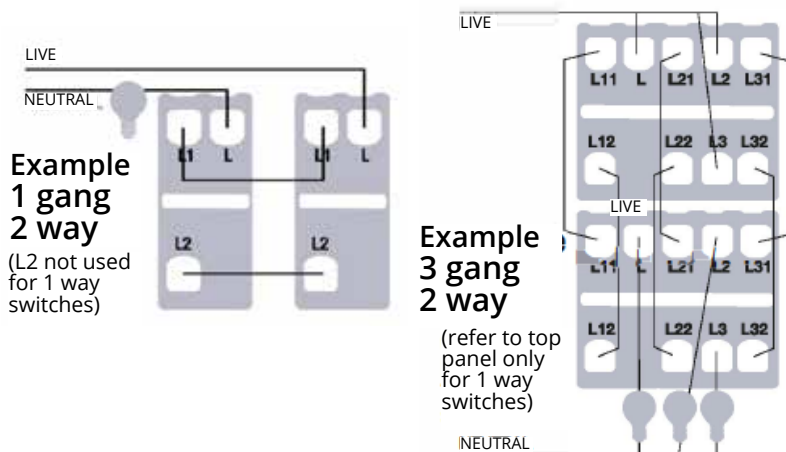

Example 1 gang 2 way
(L2 not used for 1 way switches)

Example 3 gang 2 way
(refer to top panel only for 1 way switches)

Connect the earth wire(s) to the terminal marked

Connect the live wire(s) to the terminal marked L

Connect the neutral wire(s) to the terminal marked N

It is advisable to earth all sockets with the earth leads adequately sleeved



trendiswitch.com

1 Gang and 2 Gang Screwless 13 Amp Socket

Structure

1 Gang 13 Amp Socket 2 Gang 13 Amp Single Pole Switched Socket with four 2.1 MA USB charging points

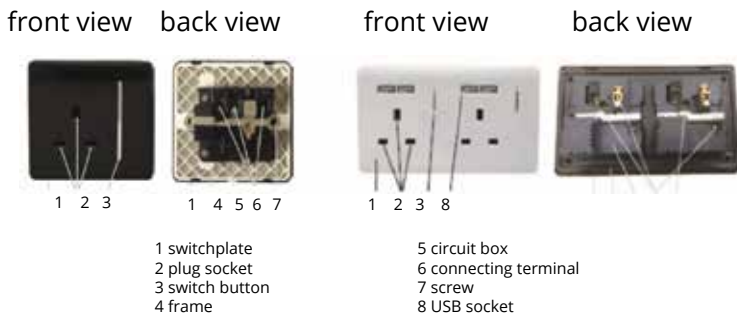

Please note: the Double USB socket wiring will need looping to connect both modules together

NB Rated voltage and power are on the circuit box
Certified to British Standard CE & CB approved

Installation

- 1 Take off switch plate from the frame along the direction of the arrow (above)
- 2 Connect wire into the connectors (see right)
- 3 Screw the frame onto the pattress box installed in the wall two screws enclosed
- 4 Clip switch plate back onto the frame, noting direction of the plate (edge with gap faces down)

Trendi Switch 1 Gang 3 Way Intermediate Switch Wiring



To fit:

- always disconnect the mains before starting
- unclip switch plate from frame
- connect wires into connectors
- screw frame into backbox in wall
- clip switch plate back onto frame for screwless finish

If in doubt, please consult a qualified electrician

To avoid tarnishing:

- do not fit to freshly plastered or damp surfaces
- do not use masking tape

For further details please go to www.trendiswitch.com/technical/

Socket Wiring

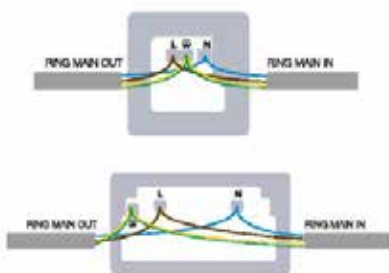

Connect the earth wire(s) to the terminal marked

Connect the live wire(s) to the terminal marked L

Connect the neutral wire(s) to the terminal marked N

It is advisable to earth all sockets with the earth leads adequately sleeved

Discover the screwless clip and unclip feature on YouTube. Simply search Trendiswitch



All Trendiswitch.com products are certified to British Standard, CE & CB approved. For more details please refer to our website www.trendiswitch.com

This is a guaranteed Trendiswitch.com product, trademark licence no.UK00003001848